

HIGOLD®

Shearer 3.0 Pro Seasoning Pull Out Basket

Installation manual



STEP - 01 -

Installation of Slide

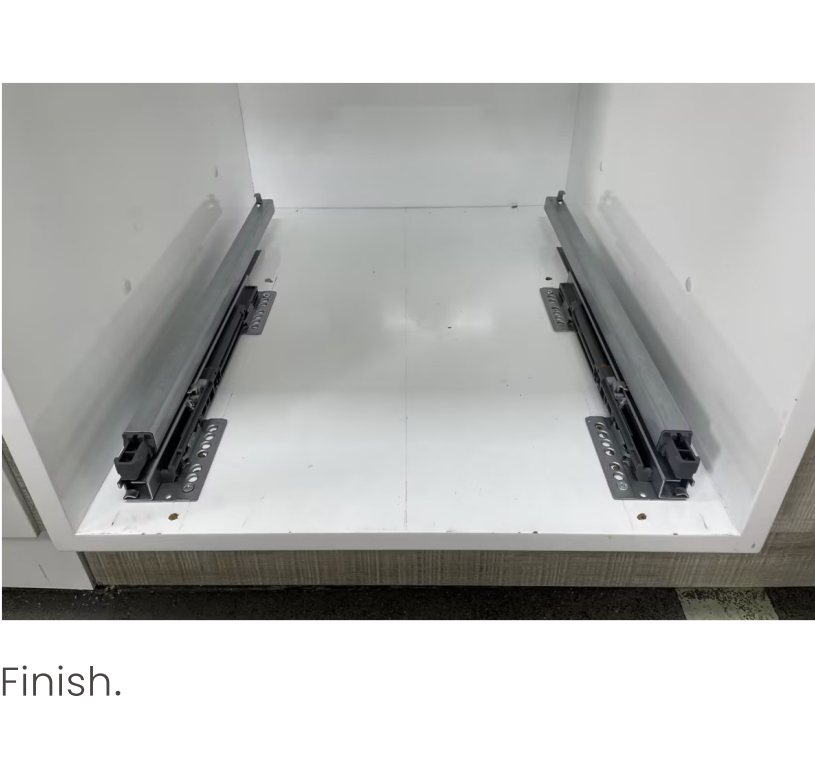

Use the installation template to pre - drill holes (left/right).

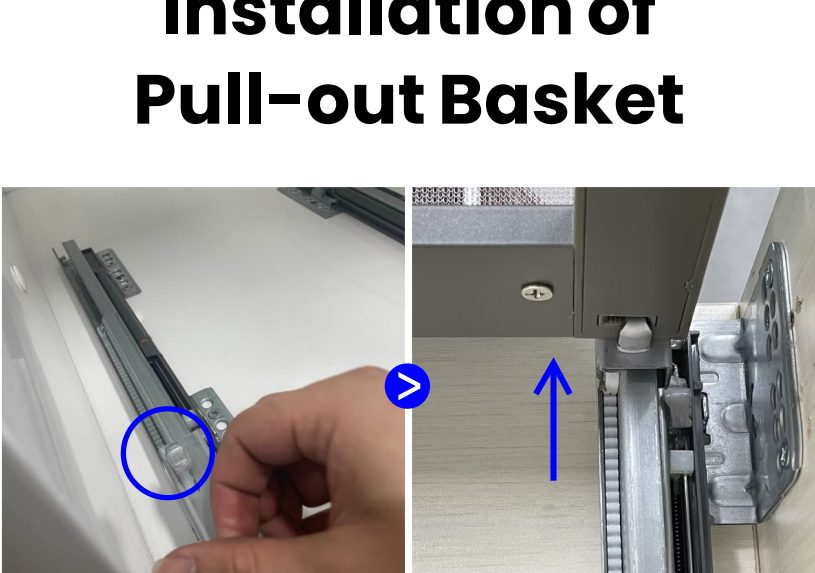

Install the slides(left/right).



Finish.

STEP - 02 -

Installation of Pull-out Basket

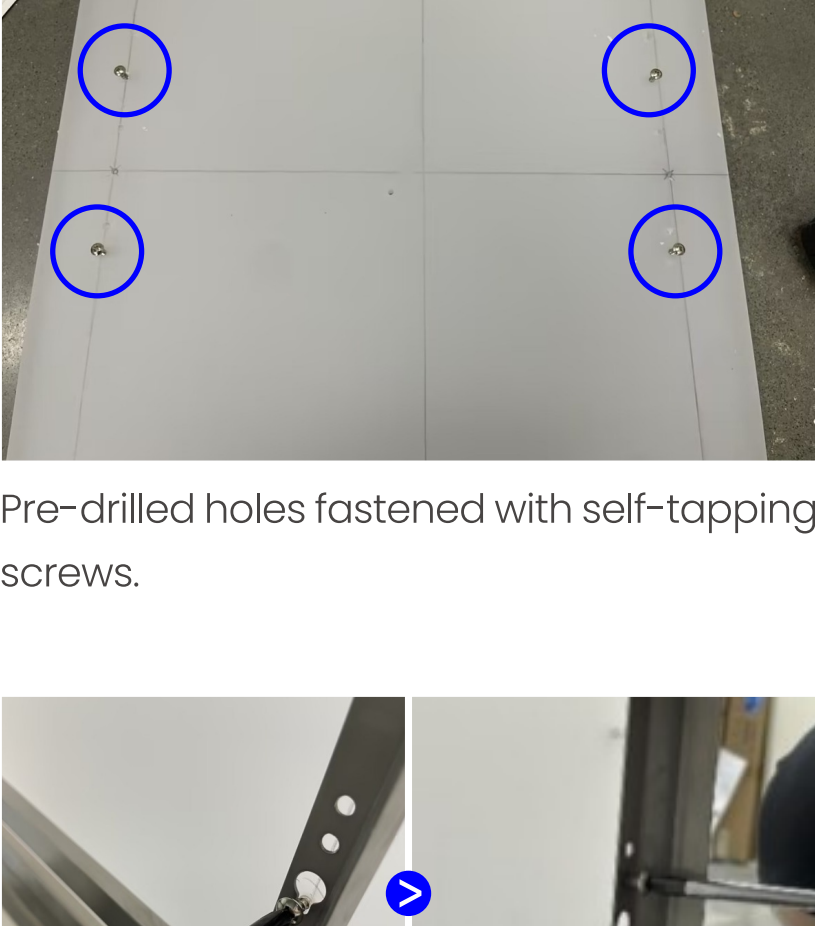

Hook slide tail into place/align front with U-clip and press down; basket installed.

STEP - 03 -

Installation of Door Panel



Pre - drill holes on door panel using installation template (left/right).



Pre-drilled holes fastened with self-tapping screws.

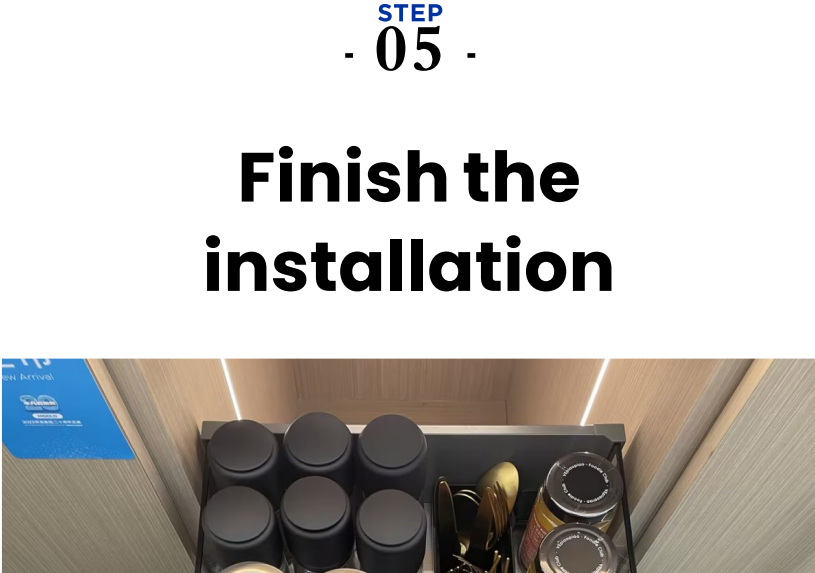

Secure door panel to basket, adjust door panel, tighten screws.

STEP - 04 -

Installation of Accessories



The high bottle basket enters diagonally from the lower end and is clamped in at both ends to complete the installation.

Install main basket, insert dividers, clip in separator plates.

STEP - 05 -

Finish the installation

Finish.

HIGOLD®

Original Design & Quality

